

LEVER HOIST – RIGTECH ELITE MODEL



APPLICATIONS

- Suitable for applications in the mining, construction, transport and automotive industries

CONSTRUCTION

- Allowable ambient conditions
 - » Operating temperature range: -10°C to +60°C
 - » Operating humidity: 100% relative humidity or less; this product should not be used under water

PRODUCT FEATURES

- Relevant standards: AS/NZS 1418.2 and EN13157
- Key internal components are CNC machined and adhere to the most stringent machine tolerances
- 'T' type hooks for improved load holding

Product Code	Rated Capacity (kg)	Lifting Height (m)	Minimum Distance Between Hooks - Hmin (mm)	No. of Load Chain Falls	Load Chain G80 (mm)	Length Lever Handle - L (mm)	Dimensions (mm)			Net Weight (kg)	Extra Weight per Meter (kg)
							A	B	C		
RTLH0.8	800	1.5	340	1	6x18	308	147	87	132	6.92	0.72
RTLH1.6	1600	1.5	400	1	7.1x21	408	170	99	145	11.23	1.08
RTLH3.2	3200	1.5	520	1	10x30	418	200	112	198	21.12	2.22

TECHNICAL DRAWINGS

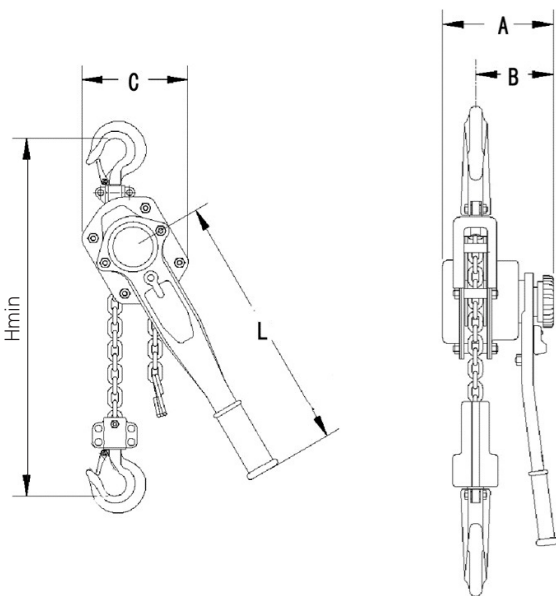

0.5t - 3.2t

SPARE PARTS

Product Code	Bottom Hook	Top Hook	Safety Latch
RTLH0.8	RTLHTH0.8	RTLHTH0.8	RTLHSL0.8
RTLH1.6	RTLHTH1.6	RTLHTH1.6	RTLHSL1.6
RTLH3.2	RTLHTH3.2	RTLHTH3.2	RTLHSL3.2